

In This Section...

T&B® Electricians' Supplies

T&B® Electricians' Supplies

Wire Connectors	G-2-G-4
Wire Installation and Wire Pulling Products	G-5-G-6
Electrician's Hand Tools	G-7
Grounding Accessories for Metal Boxes, Hardware and Rough-In Products	G-8
Hardware and Rough-In Products	G-9-G-15
Wire Testing Equipment	G-16

Carlton® Wire Management Products

Caddies and Carts	G-17
Dispensers.....	G-18
Wire Safe® Wireway and Wiring Trough	G-19-G-25

EZCODE® Label Printer

EZL500 Thermal Label Printer.....	G-26-G-28
-----------------------------------	-----------

Thomas&Betts

T&B® Electricians' Supplies, Carlton® Wire Management Products, EZCODE®

Corporate Office
Tel: 901.252.8000
800.816.7809
Fax: 901.252.1354

Customer Service
Tel: 800.816.7809
Fax: 800.816.7810

Technical Services
Tel: 888.862.3289
Fax: 901.252.1321

Tool Services
Tel: 800.284.8665

Thomas&Betts

www.tnb.com

Wire Connectors

Introducing T&B Marrette® Wire Connectors



In 1914, William Marr invented the world's first pressure-type wire connector. Since then, Marrette® connectors have become synonymous with "best quality wire connectors." Easy to install and comfortable in the hand, they are indispensable to electricians. And now they're available as key components of Thomas & Betts' Electricians' Supplies product line. This is very good news for your fingers.

How good are they?

The first thing you'll notice about T&B Marrette® wire connectors is that they come in a variety of types and styles, making it easy for you to identify wire size at a glance.

Feature for feature, here's what makes Marrette® connectors significantly better than other connectors.

- Marrette® connectors are the **ONLY** wire connector to offer a non-winged, variable-volume live-action spring in the connector. The spring expands to receive the conductors, rather than crushing them together as typical non-winged competitors do
- They can handle a broader range of wire connection combinations
- They're coated with 100% pure copper, which reduces the corrosion common to tin- and zinc-coated products
- Marrette® connectors' "finger-friendly" design offers a truer grip for less hand fatigue during repeated use
- They are the **ONLY** red non-winged connector that is UL Listed for a pair of #8 AWG wires
- The high-grade polypropylene outer shell prevents "blooming" or "blossoming" of the connector sidewall. The outer shell maintains a constant moisture level, reducing the likelihood of the connector becoming dry, brittle and subsequently cracked due to extreme heat or cold

Marrette® XTP® (Non-Winged)

CAT. NO.	WIRE RANGE*	COLOR	MIN.	MAX.
329	22-16	Gray	1#22 + 1#20	2#16
330	22-14	Blue	3#20	3#16
331	18-14	Orange	2#18	3#14
333	18-10	Yellow	1#14 + 2#18	1#10 + 2#14
335	18-8	Red	2#16 + 2#18	3#10

*AWG Solid or Stranded

CAT. NO.	DESCRIPTION	STD. CTN.
329-P	XTP-Gray	100 pc/box
329-BP	XTP-Gray	1,000 pc/bulk box
329-BK	XTP-Gray	10,000 pc/bulk box
330-P	XTP-Blue	100 pc/box
330-BP	XTP-Blue	1,000 pc/bulk box
330-BK	XTP-Blue	10,000 pc/bulk box
331-P	XTP-Orange	100 pc/bulk box
331-M	XTP-Orange	1,000 pc/masterpak®
331-KP	XTP-Orange	500 pc/bag
333-P	XTP-Yellow	100 pc/box
333-M	XTP-Yellow	1,000 pc/masterpak®
333-KP	XTP-Yellow	500 pc/bag
335-P	XTP-Red	100 pc/box
335-M	XTP-Red	500 pc/masterpak®
335-KP	XTP-Red	250 pc/bag

Marrette® Green™ 1410

- Accommodates 14 to 10 AWG ground wires
- Fulfills the need to ground wires with a UL Listed connector
- Accepts multiple ground conductors
- Swept-back wing design affords installer good leverage to make ground connections
- Swept-back wing creates less box fill

CAT. NO.	DESCRIPTION	WIRE RANGE	MIN.	MAX.	STD. CTN.
Carton Packed					
1410-P	Marrette Green	#14-10	1#14	3#10	1000
1410-KP	Marrette Green Keg Pack	#14-10	1#14	3#10	2500

T&B Set Screw Wire Connectors

Threaded brass inserts provide vibration-resistant connections that are easily removed for disconnection, visual inspection or rewiring. Thomas & Betts set screw wire connectors feature flexible, color-coded nylon insulating shells, which are compact for tight applications.

The nylon insulating shells resist heat, cold and impact with a temperature rating of 105°C (221°F) max. Rated: 600V

- Threaded brass inserts for vibration-resistant connections
- Easily removed
- Color-coded nylon insulating shells
- UL Listed and CSA Certified

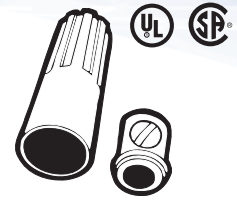

CAT. NO.	DESCRIPTION	WIRE RANGE*	MIN.	MAX.	DIMENSIONS (IN.)				STD. CTN.
					A	B	C	D	
Carton Packed									
10-305	(SS-0) Orange	18-12	2 #18	1 #12 w/ 3 #18	1 ⁵ / ₁₆	7 ¹ / ₁₆	2 ³ / ₆₄	3 ¹ / ₈	100
10-307	(SS-2) Red	18-10	6 #18	2 #10 w/ 1 #12	1 ³ / ₃₂	3 ³ / ₆₄	3 ³ / ₆₄	3 ⁵ / ₆₄	100
Bulk Packed									
10-315	(SS-0) Orange	18-12	2 #18	1 #12 w/ 3 #18	1 ⁵ / ₁₆	7 ¹ / ₁₆	2 ³ / ₆₄	3 ¹ / ₈	1000
10-317	(SS-2) Red	18-10	6 #18	2 #10 w/ 1 #12	1 ³ / ₃₂	3 ³ / ₆₄	3 ³ / ₆₄	3 ⁵ / ₆₄	1000

* Solid only

UL File E-17010; CSA File LR-6541; 10-306 and 10-316 have been superseded by IBP.

Marrette® Set Screw Vibration-Proof/Visible Connection

The Marrette® Set Screw is a two-piece, pressure-type connector featuring a solid brass insert with a screw-on insulating cap. It's the perfect choice when changing a motor, adding a circuit, conducting instrument testing or simply lashing-up temporary wiring.

External Cap

- Made of rugged, phenolic material and 150°C-rated
- Insulator cap locks securely in place to safeguard against accidental loosening in high-vibration applications

Brass Insert

- Choice of slot or Robertson set screw. When tightening into the insert, provides a solid pressure-type connection on all approved wire combinations
- No need to "re-strip" wires when rewiring. Simply loosen set screw to remove non-twisted wires

- CSA (LR6591), UL (424H) — approved for circuits up to 600V and lighting fixtures and signs up to 1,000V
- Convenient packaging — sized right and jobsite ready!

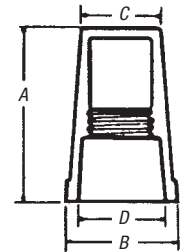

Marrette Set Screws

CAT. NO.	DESCRIPTION	WIRE RANGE	STD. CTN.	STD. PKG.
1SHP	Marr Set Screw Small Robertson	#18-12	100	1000
2SHP	Marr Set Screw Large Robertson	#18-10	100	1000
1C-CDN	Marr Set Screw Small Slot-Head	#18-12	3/Card	10 Cards
2C-CDN	Marr Set Screw Large Slot-Head	#18-10	3/Card	10 Cards

Crimp Sleeve Wire Connectors

- Zinc plated, chromate-treated steel
- Two sizes accommodate #18-8 AWG copper
- UL Listed and CSA Certified

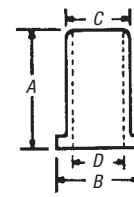

CAT. NO.	DESCRIPTION	WIRE RANGE*	MIN.	MAX.	DIMENSIONS (IN.)				STD. CTN.
					A	B	C	D	
Carton Packed									
10-500	(Hi-410)	18-10*	1 #14 w/ 1 #18	2 #10 w/ 1 #12	3⁄8	19⁄64	¼	13⁄64	50
10-501	(Hi-411)	18-8	3 #12	4 #10	39⁄64	23⁄64	5⁄16	17⁄64	50
Bulk Packed									
10-510	(Hi-410)	18-10*	1 #14 w/ 1 #18	2 #10 w/ 1 #12	3⁄8	19⁄64	¼	13⁄64	1000
10-511	(Hi-411)	18-8	3 #12	4 #10	39⁄64	23⁄64	5⁄16	17⁄64	1000

* Stranded only

Installation tool 18-500

Corporate Office
Tel: 901.252.8000
800.816.7809
Fax: 901.252.1354

Customer Service
Tel: 800.816.7809
Fax: 800.816.7810

Technical Services
Tel: 888.862.3289
Fax: 901.252.1321

Tool Services
Tel: 800.284.8665

Thomas & Betts

www.tnb.com

Wire Connectors

Porcelain Wire Connectors — High Temperature

- For high-temperature applications over 105°C
- Three sizes accommodate #18-14 AWG stranded copper
- 300V Rated
- UL Listed and CSA Certified
- UL Standard 486C

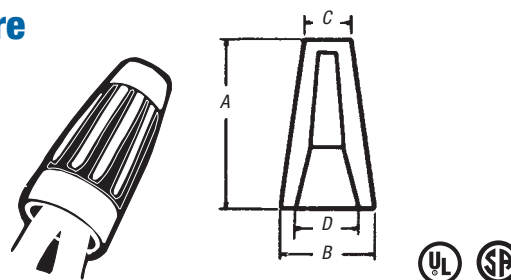

CAT. NO.	DESCRIPTION	WIRE RANGE*	MIN.	MAX.	DIMENSIONS (IN.)				STD. CTN.
					A	B	C	D	
Carton Packed									
10-401	(Hi-1)	18-14	2 #18	1 #18 w/ 2 #16	1 ¹ / ₁₆	1 ³ / ₃₂	3 ¹ / ₁₆	1 ¹ / ₄	100
10-405	(Hi-5)	18-14	2 #18	2 #16 w/ 2 #18	3 ¹ / ₄	3 ¹ / ₆₄	1 ³ / ₆₄	5 ¹ / ₁₆	100
10-407	(Hi-7)	18-14	2 #18	4 #16	2 ¹ / ₃₂	1 ¹ / ₃₂	7 ¹ / ₃₂	1 ³ / ₃₂	100
Multi-Carton Packed									
10-411	(Hi-1)	18-14	2 #18	1 #18 w/ 2 #16	1 ¹ / ₁₆	1 ³ / ₃₂	3 ¹ / ₁₆	1 ¹ / ₄	1,000
10-415	(Hi-5)	18-14	2 #18	2 #16 w/ 2 #18	3 ¹ / ₄	3 ¹ / ₆₄	1 ³ / ₆₄	5 ¹ / ₁₆	1,000
10-417	(Hi-7)	18-14	2 #18	4 #16	2 ¹ / ₃₂	1 ¹ / ₃₂	7 ¹ / ₃₂	1 ³ / ₃₂	1,000
Bulk Packed									
10-421	(Hi-1)	18-14	2 #18	1 #18 w/ 2 #16	1 ¹ / ₁₆	1 ³ / ₃₂	3 ¹ / ₁₆	1 ¹ / ₄	10,000
10-425	(Hi-5)	18-14	2 #18	2 #16 w/ 2 #18	3 ¹ / ₄	3 ¹ / ₆₄	1 ³ / ₆₄	5 ¹ / ₁₆	5,000
10-427	(Hi-7)	18-14	2 #18	4 #16	2 ¹ / ₃₂	1 ¹ / ₃₂	7 ¹ / ₃₂	1 ³ / ₃₂	5,000

* Stranded only

UL File E-17010; CSA File LR-6541.

Marrette® Black™ High-Temperature Wire Connectors

The Marrette® Black™ connector's high-temperature rating makes it the best solution for high-wattage lighting fixtures and signs.

External Cap

- Made of rugged, phenolic material and 150°C-rated
- Large, finely ribbed, "barrel-shaped" cap — makes it easier to grip even when hands are greasy or damp
- Deep, wide throat ensures full insulation coverage
- Threaded entry helps guide large wire bundles right into the spring

Inner Spring

- Internal round spring design multiplies the "twist-on" torque applied by the leverage and wedge action to firmly crush wires into a solid joint
- Unique copper-coated spring helps resist corrosion
- CSA (LR6591), UL (424H)
 - Model Nos. 29 & 30 Black™ are approved for circuit and fixture type connections up to 300V only
 - Model Nos. 31, 33, & 35 Black™ are approved for circuits up to 600V, and lighting fixtures and signs up to 1,000V

- Convenient packaging — sized right and jobsite ready!



CAT. NO.	WIRE DESCRIPTION	RANGE	MODEL	STD. CTN.
30P	Black	#22-14	30	1,000
30BP	Black	#22-14	30	1,000
30BK	Black	#22-14	30	10,000
31P	Black	#18-14	31	1,000
31KP	Black	#18-14	31	5,000
31BP	Black	#18-14	31	1,000
31BK	Black	#18-14	31	10,000
33P	Black	#18-12	33	1,000
33KP	Black	#18-12	33	5,000
33BP	Black	#18-12	33	10,000
33BK	Black	#18-12	33	10,000
35P	Black	#18-10	35	1,000
35KP	Black	#18-10	35	2,500
35BP	Black	#18-10	35	1,000
35BK	Black	#18-10	35	5,000

Wire Installation and Wire Pulling Products

Wire Pulling Lubricant — Semi-Synthetic Base

T&B offers a choice of wire and cable pulling lubricants. The popular standard base, cold weather and advanced engineered polymer-base lubricants are available. Each features superior stability, adherence and cable compatibility as well as excellent lubricating properties.

- Preferred semi-synthetic base formulation
- Retains lubricating properties and will not separate up to 200°F
- Will not separate after freezing
- Superior adherence to cable
- Recommended for use on all commonly used wire and cable, including high-voltage cable and all UL Listed conduits
- Dries to slick, waxy film
- Non-toxic, no silicones, non-staining, easy cleanup

Technical Information

1. pH: 7.9
2. Coefficient of Friction (wet and dry residue)
sliding wet — 0.07
sliding dry — 0.08
3. Color: yellow
4. Weight per Gallon: 8.26 lbs.
5. Freezing Point: +25°F (-4°C)
6. High-Temperature Stability: 200°F (93°C)
7. Non-toxic, non-staining, contains no silicones

NOTE: Additional test data available upon request.



CAT. NO.	DESCRIPTION	STD. CTN.
15-231	1 Gallon	4

Suitable for use with wire or cable insulated with rubber (R, RH, etc.), Neoprene, nylon and PVC plastics (T, TW, THW, THHN, etc.), Hypalon*, high-density polyethylene and Cross Linked Polyethylene (XLP). Not recommended for use on asbestos or low-density polyethylene insulated cables. Compatible with semiconducting jackets present on high-voltage cable. Meets the requirements of ICEA Standards:

ICEA #S-61-402/NEMA Pub. #WC5

ICEA #S-66-524/NEMA Pub. #WC7

UL File E-43782.

*Hypalon is a registered trademark of E.I. DuPont.

For 24-hour safety and MSDS requirements, call Chemtrec at 800-424-9300.

WireSlick™ Wire and Cable Pulling Lubricant*

WireSlick™ wire and cable pulling lubricant represents the latest in polymer technology. An economical formulation, WireSlick™ polymer-base lubricant provides extremely good thermal stability and a lower freezing point (20°F) than clay-, soap- or wax-base formulations.

WireSlick™ is recommended for use with wire or cable insulated with rubber (R, RH, etc.), Neoprene; nylon and PVC plastics (T, TW, THW, THHN, etc.); Hypalon*; High-Density Polyethylene and Cross-Linked Polyethylene (XLP). It is also compatible with high-voltage cable with semi-conducting jackets.

WireSlick™ has been tested and passes the requirements of ICEA Standards:

ICEA #S-61-402/NEMA Pub. #WC5

ICEA #S-66-524/NEMA Pub. #WC7

- Polymer-base formulation
- Universally compatible with all types of wire and cable
- Widely used by power and telephone utilities
- Economical lubricant

Technical Information

1. pH: 8.2
2. Coefficient of Friction (wet and dry residue)
sliding wet — 0.11
sliding dry — 0.17
3. Color: orange
4. Weight per Gallon: 10 lbs.
5. Freezing Point: +20°F (-7°C)
6. High-Temperature Stability: 200°F (93°C)
7. Non-toxic, non-staining, contains no silicones

NOTE: Additional test data available upon request.

*Hypalon is a registered trademark of E.I. DuPont.

Wire and Cable Pulling Lubricant



CAT. NO.	DESCRIPTION	STD. CTN.
15-631	1 Gallon Pail	4

* For 24-hour safety and MSDS requirements, call Chemtrec at 800-424-9300.

UL File E-43782.

Corporate Office
Tel: 901.252.8000
800.816.7809
Fax: 901.252.1354

Customer Service
Tel: 800.816.7809
Fax: 800.816.7810

Technical Services
Tel: 888.862.3289
Fax: 901.252.1321

Tool Services
Tel: 800.284.8665

Thomas & Betts

www.tnb.com

Wire Installation and Wire Pulling Products

Conduit Benders

T&B Conduit Benders include manual benders and hickies for easy and accurate bending of ½" to 1½" EMT and ¼" to 1" rigid and IMC conduit.

From the unparalleled durability of our Ductile-Iron Benders to economical Aluminum-Alloy Benders, T&B offers you a choice. High-strength, case-hardened handles are also available for a bending system designed to last a lifetime.

- Durable construction
- Embossed benchmark symbols and degree scales "raised indices"
- Flat-backed hook
- Offset bending guide included on each handle
- 40% stronger than malleable iron
- Traditional design with increased strength
- Guaranteed against breakage for life
- Extended foot pedal



Ductile-Iron Conduit Benders

CAT. NO.	DESCRIPTION	FOR BENDING	USE HANDLE	STD. CTN.
18-710	Hickey*	½" EMT	18-719	10

* Malleable Iron

7" Awl

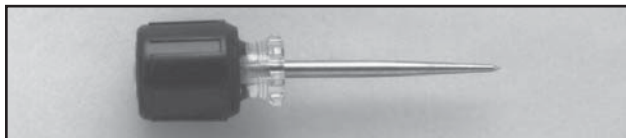

- Comfortable cushion-grip handle that is small enough for working in obstructed areas
- Constructed of hardened and tempered steel for strength and durability
- Convenient precision-ground tip can be resharpened

CAT. NO.	DESCRIPTION	STD. CTN.
18-AWL	7" Awl	5

Cable Cutter

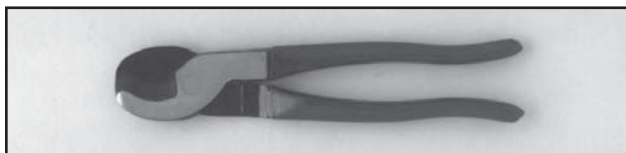

- Designed to cut 4/0 aluminum and up to 2/0 soft copper
- Manufactured to meet or exceed U.S. government specifications

CAT. NO.	DESCRIPTION	STD. CTN.
18-CC9	Cable Cutter	5

Hex Key Sets

- Three sets cover .050 through 5/8" hex size range
- Constructed of hardened or tempered chromium nickel alloy steel

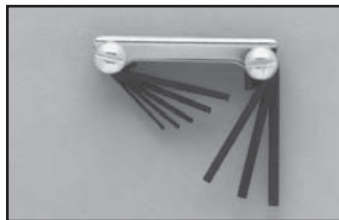

CAT. NO.	DESCRIPTION	STD. CTN.
18-275	.050 to 5/8", 8 Key Sizes	6

8" Diagonal Pliers

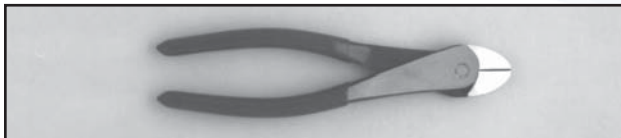

CAT. NO.	DESCRIPTION	STD. CTN.
18-DP8	8" Diagonal	5

Screw Starter



CAT. NO.	DESCRIPTION	STD. CTN.
18-265	Screw Starter 6" (Card Display)	10
18-266	Screw Starter 9" (Card Display)	10

Cable Rippers

- Slits outer jacket from Romex and other non-metallic (NM) sheathed cable

Model 18-223

- Made from cast aluminum; has replaceable blades
- For 2 or 3 wire #14, #12 or #10 with or without ground

CAT. NO.	DESCRIPTION	WIRE RANGE	STD. CTN.
18-223	Cable Ripper for 2 or 3 Wires	#14, #12 or #10	12
18-201	Replacement Blade for 18-223	—	1

Wire and Cable Cutting and Stripping Tool



CAT. NO.	DESCRIPTION	STD. CTN.
ERG1-WS	Self-Adjusting, Cutting and Stripping Tool	1

Grounding Accessories for Metal Boxes, Hardware and Rough-In Products

Grounding Screws

- Color-coded green
- Size 10-32 x $\frac{1}{2}$, fits tapped screw hole in most boxes
- Cat. No. 11-104 taps its own threads

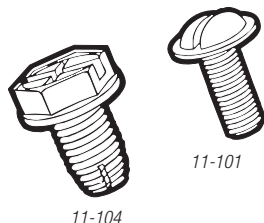

CAT. NO.	DESCRIPTION	STD. CTN.
11-101	Washer Head Screws	1,000
11-104	Hex/Phillips/Slotted Head Self-Tapping	1,000

Anchors — Metallic

Lead Expansion Anchors

- For heavy-duty anchoring in solid masonry
- One setting tool supplied in each standard carton; no screws supplied



CAT. NO.	SCREW SIZE	HOLE DEPTH (IN.)	DRILL SIZE	STD. CTN.
53-308	$\frac{1}{4}$ -20	$\frac{3}{4}$	$\frac{1}{2}$	500
53-312	$\frac{3}{8}$ -16	1 $\frac{1}{4}$	$\frac{3}{4}$	250
53-314	$\frac{1}{2}$ -13	1 $\frac{1}{2}$	$\frac{3}{4}$	250

Lead Anchor Kits

- Lead expansion anchors and setting tool in reusable plastic box



CAT. NO.	DESCRIPTION	STD. CTN.
53-380	50 No. $\frac{1}{4}$ -20 Anchors	12
53-384	100 No. 10-24 Anchors	12

Hollow Wall Anchor

- Permanent anchor for fastening to plaster, plywood, wallboard, glass, metal or marble



CAT. NO.	SIZE	LENGTH (IN.)	FOR WALL THICKNESS (IN.)	DRILL SIZE	STD. CTN.
53-841	$\frac{1}{8}$ -S	1 $\frac{1}{2}$	$\frac{1}{4}$ - $\frac{3}{4}$	$\frac{1}{4}$	1,000
53-842	$\frac{1}{8}$ -L	1 $\frac{5}{8}$	$\frac{3}{8}$ -1 $\frac{1}{4}$	$\frac{1}{4}$	1,000
53-861	$\frac{3}{16}$ -S	2 $\frac{1}{8}$	$\frac{1}{4}$ - $\frac{5}{8}$	$\frac{3}{8}$	500
53-862	$\frac{3}{16}$ -L	2 $\frac{3}{4}$	$\frac{3}{8}$ -1 $\frac{1}{4}$	$\frac{3}{8}$	500
53-881	$\frac{1}{4}$ -S	2 $\frac{1}{4}$	$\frac{1}{2}$ - $\frac{3}{4}$	1 $\frac{1}{2}$	500
53-882	$\frac{1}{4}$ -L	2 $\frac{3}{4}$	$\frac{3}{4}$ -1 $\frac{1}{4}$	1 $\frac{1}{2}$	500

Hammer Drive Pins

- For fast fastening to metal, concrete and cinder blocks without drilling
- Pins are hardened to penetrate, yet tough and ductile to hold without breaking
- Compact driving tool sets pins perfectly

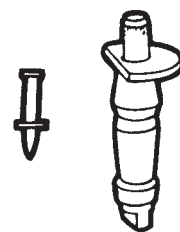

CAT. NO.	HEAD DIAMETER (IN.)	SHANK DIAMETER (IN.)	OVERALL LENGTH (IN.)	STD. CTN.
53-551	$\frac{1}{4}$	$\frac{3}{16}$	$\frac{1}{2}$	1,000
53-552	$\frac{1}{4}$	$\frac{3}{16}$	$\frac{3}{4}$	1,000
53-553	$\frac{1}{4}$	$\frac{3}{16}$	1	1,000
53-554	$\frac{1}{4}$	$\frac{3}{16}$	1 $\frac{1}{4}$	1,000
53-555	$\frac{1}{4}$	$\frac{3}{16}$	1 $\frac{1}{2}$	1,000
53-556	$\frac{1}{4}$	$\frac{3}{16}$	2	1,000
53-557	$\frac{1}{4}$	$\frac{3}{16}$	2 $\frac{1}{2}$	500
53-533	$\frac{1}{4}$	Compact Tool	—	6

Toggle Bolts

- "Spring-Wing" type, zinc plated
- Bolts are threaded full length
- Available with mushroom head on seven most popular sizes



CAT. NO.	MUSHROOM HEAD	SIZE	DRILL HOLE (IN.)	STD. CTN.
52-500	52-600	$\frac{1}{8}$ (6-32) x 2	$\frac{3}{16}$	250
52-502	52-602	$\frac{1}{8}$ (6-32) x 3	$\frac{3}{16}$	250
52-504	52-604	$\frac{1}{8}$ (6-32) x 4	$\frac{3}{16}$	250
52-520		$\frac{3}{16}$ (10-24) x 2	$\frac{9}{16}$	250
52-522	52-622	$\frac{3}{16}$ (10-24) x 3	$\frac{9}{16}$	250
52-524	52-624	$\frac{3}{16}$ (10-24) x 4	$\frac{9}{16}$	250
52-530		$\frac{1}{4}$ -20 x 2	$\frac{3}{4}$	250
52-532	52-632	$\frac{1}{4}$ -20 x 3	$\frac{3}{4}$	250
52-534	52-634	$\frac{1}{4}$ -20 x 4	$\frac{3}{4}$	250
52-536		$\frac{1}{4}$ -20 x 5	$\frac{3}{4}$	250
52-538		$\frac{1}{4}$ -20 x 6	$\frac{3}{4}$	250
52-548		$\frac{3}{8}$ -16 x 3	1	250
52-550		$\frac{3}{8}$ -16 x 4	1	250
52-552		$\frac{3}{8}$ -16 x 5	1	250
52-554		$\frac{3}{8}$ -16 x 6	1	250

Anchors — Non-Metallic

Red-Cap® Screw Anchors

- Superior holding power in solid masonry or concrete block



CAT. NO.	SIZE	FOR TAPPING SCREWS		DRILL* HOLE (IN.)	STD. CTN.
		SIZE	LENGTH (IN.)		
50-210	#8 x ¾"	6, 7 or 8	1-1¼	⅝	1,000
50-230	#12 x 1"	9, 10 or 12	1-1¼	¾	1,000
50-250	#16 x 1½"	14 or 16, ¼" Lag Screw	1¼-1½	⅝	500

Bulk

50-219	#8 x ¾"	6, 7 or 8	1-1¼	⅝	10,000
50-239	#12 x 1"	9, 10 or 12	1-1¼	¾	10,000
50-259	#16 x 1½"	14 or 16, ¼" Lag Screw	1¼-1½	⅝	10,000

* When impact hammer drill is used, downsize drill hole ⅛".

NOTE: For maximum holding power, select screw length ¼" longer than anchor.

Red-Cap® Anchor Kits

- Red Cap® anchors, screws and drill bit in reusable plastic kit box



CAT. NO.	DESCRIPTION	STD. CTN.
51-208	(100) #8 Anchors (100) 6 x 1" Panhead Screws (1) ⅝" Carbide-Tip Drill Bit	12
51-212*	(100) #12 Anchors (100) 10 x 1" Combination Slot/Phillips Head Screws (1) ¾" Carbide-Tip Drill Bit	12
51-212HX	(100) #12 Anchors (100) 10 x 1" Hex-Slotted Screws (1) ¾" Carbide-Tip Drill Bit	12
51-216	(50) #16 Anchors (50) 14 x 1¼" Panhead Screws (1) ⅝" Carbide-Tip Drill Bit	12

* Now with combination Slot/Phillips screws.

Economy Plastic Screw Anchor

- Superior holding power in solid masonry or concrete block



CAT. NO.	SIZE	FOR TAPPING SCREWS		DRILL* HOLE (IN.)	STD. CTN.
		SIZE	LENGTH (IN.)		
50-404	#12 x 1"	10 to 12	1	¾	1,000

* When impact hammer drill is used, downsize drill hole ⅛".

Economy Screw Anchor Kits



CAT. NO.	DESCRIPTION	STD. CTN.
51-404*	(100) #12 x 1" Screw Anchor (100) 10 x 1" Slot/Phillips Head Screws (1) ¾" Carbide-Tip Drill Bit	12
51-404HX	(100) #12 x 1" Screw Anchor (100) 10 x 1" Hex-Slotted Screws (1) ¾" Carbide-Tip Drill Bit	12

* Now with Slot/Phillips screws.

Hi-Drive™ Nail Anchors

- For use in concrete, masonry, blocks, stone or plaster
- Dependable, low-cost, lightweight anchoring



CAT. NO.	SIZE (IN.)	DRILL* HOLE (IN.)	STD. CTN.
50-811	⅝" x 1	⅝	1,000
50-831	¾" x 1	¾	1,000

* When impact hammer drill is used, downsize drill hole ⅛".

Hi-Drive™ Nail Anchor Kit

CAT. NO.	DESCRIPTION	STD. CTN.
51-850	(100) ⅝" x 1" Anchors w/ Nails (1) ⅝" Carbide-Tip Drill Bit	12
51-852	(100) ¾" x 1" Anchors w/ Nails (1) ¾" Carbide-Tip Drill Bit	12

Anchors, nails and drill bit in reusable plastic kit box.

Hardware and Rough-In Products

Machine Bolts

- Steel, zinc plated
- Accurate, uniform threads
- Round heads standard; flat heads available in some sizes

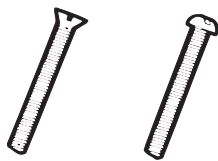

CAT. NO. ROUND HEAD	CAT. NO. FLAT HEAD	SIZE	STD. CTN.
54-521	54-621	6-32 x 1/2"	1,000
54-522	54-622	6-32 x 3/4"	1,000
54-523	54-623	6-32 x 1"	1,000
54-524	54-624	6-32 x 1 1/4"	1,000
54-525	54-625H	6-32 x 1 1/2"	1,000
54-526	54-626	6-32 x 2"	1,000
54-527	54-627	6-32 x 2 1/2"	1,000
54-541P		8-32 x 1/2"	1,000
54-542P	54-642	8-32 x 3/4"	1,000
54-543P	54-643	8-32 x 1"	1,000
54-544		8-32 x 1 1/4"	1,000
54-545P	54-645H	8-32 x 1 1/2"	1,000
54-546P	54-646	8-32 x 2"	1,000
54-547		8-32 x 2 1/2"	500
54-548		8-32 x 3"	500
54-551		10-24 x 1/2"	1,000
54-552		10-24 x 3/4"	1,000
54-553		10-24 x 1"	1,000
54-554		10-24 x 1 1/4"	1,000
54-555		10-24 x 1 1/2"	1,000
54-556		10-24 x 2"	500
54-561		10-32 x 1/2"	1,000
54-562		10-32 x 3/4"	1,000
54-563P		10-32 x 1"	1,000
54-564		10-32 x 1 1/4"	1,000
54-565		10-32 x 1 1/2"	1,000
54-566		10-32 x 2"	500
54-570P		1/4-20 x 3/8"	1,000
54-571P		1/4-20 x 1/2"	1,000
54-572P		1/4-20 x 3/4"	500
54-573P		1/4-20 x 1"	500
54-574		1/4-20 x 1 1/4"	500
54-575		1/4-20 x 1 1/2"	1,000
54-576		1/4-20 x 2"	500
54-577		1/4-20 x 2 1/2"	250
54-578		1/4-20 x 3"	250

Hexagon Nuts

- For use with machine bolts
- Finest quality steel, zinc plated



CAT. NO.	SIZE	STD. CTN.
55-004P	6-32	1,000
55-005P	8-32	1,000
55-006P	10-24	1,000
55-007P	10-32	1,000
55-008P	1/4-20	1,000
55-010	5/16-18	1,000
55-012	3/8-16	1,000

Self-Piercing Screws

- For fastening to sheet metal up to .040 (25 gauge)
- Eliminates pre-drilled holes
- 1/4" Hex Washer head, slotted; fits 54-090 Magnetic Driver



CAT. NO.	SIZE	STD. CTN.
54-001	7 x 1/2"	1,000
54-002	8 x 1/2"	1,000
54-003	8 x 3/4"	1,000
54-004P	10 x 1/2"	1,000
54-005P	10 x 3/4"	1,000
54-006P	10 x 1"	1,000
54-007P	10 x 1 1/4"	1,000
54-008P	10 x 1 1/2"	1,000
54-009P	10 x 2"	1,000

Self-Drilling Screws

- Drill their own hole and form mating threads
- #8 screws fasten combined material thickness up to 1/2"
- #10 screws fasten combined material thickness up to 3/4"
- Hex Washer Head (no slot)
- 1/4" hex head fits 54-090 Magnetic Driver
- 5/16" hex head fits 54-091 Magnetic Driver



CAT. NO.	SIZE	HEAD SIZE (IN.)	POINT NO.	STD. CTN.
54-300P	8 x 1/2"	1/4	2	1,000
54-301	8 x 3/4"	1/4	2	1,000
54-302P	10 x 5/8"	5/16	3	1,000
54-303P	10 x 1"	5/16	3	1,000
54-304	12-14 x 3/4"	5/16	3	1,000

Magnetic Drivers

- For driving self-piercing and self-drilling hex head screws
- Fits power screwdriver and electric drill chucks
- Strong permanent magnet holds screw in position



CAT. NO.	SIZE	STD. CTN.
54-091	5/16" x 1 5/8" Hex-Head Magnetic Driver	12
54-090	1/4" x 1 1/4" Hex-Head Magnetic Driver	12

Hardware and Rough-In Products

Slotted Tapping Screws

- For fastening to wood or sheet metal
- Best screw for use with plastic screw anchors
- Large "pan-head" eliminates need for a washer in many applications
- Zinc-plated steel

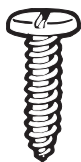

CAT. NO.	SIZE	STD. CTN.
54-121	6 x 1/2"	1,000
54-122P	6 x 3/4"	1,000
54-123P	6 x 1"	1,000
54-124P	6 x 1 1/4"	1,000
54-141	8 x 1/2"	1,000
54-142P	8 x 3/4"	1,000
54-143P	8 x 1"	1,000
54-144	8 x 1 1/4"	1,000
54-145P	8 x 1 1/2"	1,000
54-155P	10 x 1 1/2"	1,000
54-156	10 x 2"	1,000
54-161	12 x 1/2"	1,000
54-162P	12 x 3/4"	1,000
54-163P	12 x 1"	500
54-164	12 x 1 1/4"	500
54-165P	12 x 1 1/2"	500
54-166	12 x 2"	500

Slotted Tapping Screws

- Indented hex washer slotted-type head
- One 1/4" hex driver accommodates all sizes
- Sharp tapered point



CAT. NO.	SIZE	STD. CTN.
54-100Z	7 x 1/2"	500
54-141ZP	8 x 1/2"	500
54-142ZP	8 x 3/4"	500
54-143Z	8 x 1"	—
54-151ZP	10 x 1/2"	500
54-152ZP	10 x 3/4"	500
54-153Z	10 x 1"	500

Tapping Screws — Pan Head Square Drive

- Drive fastener locks onto the square drive bit
- Used in difficult-to-apply locations
- Used in mobile home and aluminum building products

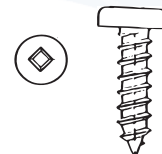

CAT. NO.	SIZE	STD. CTN.
54-841	8 x 1/2"	500
54-842	8 x 3/4"	100
54-843P	8 x 1"	500
54-844	8 x 1 1/4"	500
54-845	8 x 1 1/2"	—
54-851P	10 x 1/2"	500
54-852P	10 x 3/4"	500
54-853P	10 x 1"	500
54-854P	10 x 1 1/4"	—
54-855P	10 x 1 1/2"	500
54-856	10 x 2"	500
54-861	12 x 1/2"	500
54-862P	12 x 3/4"	500
54-863	12 x 1"	500
54-864	12 x 1 1/4"	500
54-866	10 x 2"	—

Hardware and Rough-In Products

Drywall Screws

- For use in up to 12 gauge steel
- Phillips bugle head black-coated steel designed to penetrate drywall and drilling hole in metal studs up to 12 gauge thick



100 Pack — Framing Style

CAT. NO.	DIAMETER THREAD	LENGTH (IN.)	STD. CTN.
54-00SD	6	1	100
54-01SD	6	1¼	100
54-02SD	6	1½	100
54-03SD	6	1¾	100
54-04SD	8	2¾	100
54-05SD	8	3	100

1,000 Pack — Framing Style

CAT. NO.	DIAMETER THREAD	LENGTH (IN.)	STD. CTN.
54-10SD	6	1	1,000
54-11SD	6	1¼	1,000
54-12SD	6	1½	1,000
54-13SD	6	1¾	1,000
54-14SD	8	2¾	1,000
54-15SD	8	3	1,000

100 Pack — Self Drilling and Piercing

CAT. NO.	DIAMETER THREAD	LENGTH (IN.)	STD. CTN.
54-00DW	6	1	100
54-01DW	6	1¼	100
54-02DW	6	1½	100
54-03DW	6	2	100
54-04DW	6	2¼	100
54-05DW	8	2½	100
54-06DW	8	3	100

1,000 Pack — Self Drilling and Piercing

CAT. NO.	DIAMETER THREAD	LENGTH (IN.)	STD. CTN.
54-10DW	6	1	1,000
54-11DW	6	1¼	1,000
54-12DW	6	1½	1,000
54-13DW	6	2	1,000
54-14DW	6	2¼	1,000
54-15DW	8	2½	1,000
54-16DW	8	3	1,000

Wall Plate Screws

- Oval head screws ¾" long; 6-32 thread
- Brown- and ivory-colored nylon screws eliminate static shocks
- Steel screws have variety of head finishes to match specified decor
- Screws are packaged in clear, reclosable plastic tube
- 55-660 Kit contains one tube of each screw in a reusable plastic kit box

CAT. NO.	SIZE	STD. CTN.	STD. PKG.
55-660	K-60 Kit (600 Screws)	—	—
Individual Tubes			
55-611	Ivory Nylon Screws	—	100
55-612	Ivory (Painted) Screws	—	—
55-613	Bright Nickel Screws	—	100
55-614	Brass-Plated Screws	—	100
55-615	Brown Nylon Screws	100	100
55-616	Bronze-Plated Screws	—	100

Fender Washers

- Steel, zinc plated
- Round, perfectly centered holes, uniform thickness
- Smooth rounded edges are kind to fingers



CAT. NO.	BOLT SIZE (IN.)	I.D. (IN.)	O.D. (IN.)	THICK (IN.)	STD. CTN.
55-201	¼	⅜	¾	.062	1,000
55-202	¼	⅜	¾	.047	1,000
55-203	⅜	1¼	1½	.047	1,000
55-204	⅜	1½	1	.062	1,000
55-206	¼	⅜	¾	.047	1,000
55-207	¼	⅜	¾	.047	1,000
55-208P	¼	⅜	1	.047	1,000
55-210P	⅜	1¼	1¼	.062	500
55-211P	⅜	1¼	1¼	.074	500
55-212P	¼	⅜	1½	.062	500
55-213	½	1¾	2	.062	500
55-214	⅜	1¼	1½	.062	500
55-218P	¼	⅜	1¼	.062	500

Lock Washers

- Split, spring type with high resiliency
- Steel, zinc plated



CAT. NO.	SIZE (IN.)	STD. CTN.
55-230P	(10) ⅜	1,000
55-234P	¼	1,000
55-235P	⅜	1,000
55-236P	¾	1,000
55-238	½	1,000

Hardware and Rough-In Products

Snap-In Blanks

- Steel
- Zinc plated
- Used for replacing knockouts in outlet boxes



CAT. NO.	SIZE (IN.)	DIAMETER (IN.)	STD. CTN.
BL-111	1/2	1 1/4	1,000
BL-112	3/4	1 1/4	1,000
BL-113	1	1 1/2	1,000
BL-114	1 1/4	1 3/8	500
BL-115	1 1/2	2 1/2	500
BL-116	2	2 1/8	250

Plastic Clamps — Nylon

- Nylon
- Screw hole size .203 for #10 screw
- Temperature range -40°F to 176°F



CAT. NO.	DESCRIPTION	DIMENSIONS (IN.)				STD. CTN.
		D	W	T	E	
12-102	(NPC-2)	1/8	3/8	3/4	2 1/4	1,000
12-103	(NPC-3)	3/16	3/8	3/4	3/8	1,000
12-104	(NPC-4)	1/4	3/8	3/4	13/32	1,000
12-105	(NPC-5)	5/16	3/8	3/4	29/64	1,000
12-106	(NPC-6)	3/8	3/8	3/4	15/32	1,000
12-107	(NPC-7)	1/2	3/8	3/4	33/64	1,000
12-108	(NPC-8)	1/2	3/8	3/4	35/64	1,000
12-109	(NPC-9)	9/16	1/2	1/2	5/8	1,000
12-110	(NPC-10)	5/8	1/2	1/2	21/32	1,000
12-111	(NPC-11)	1 1/16	1/2	1/2	47/64	1,000
12-112	(NPC-12)	3/4	1/2	1/2	25/32	500
12-114	(NPC-14)	7/8	1/2	1/2	27/32	—
12-116	(NPC-16)	1	1/2	1/2	29/32	—
12-118	(NPC-18)	1 1/8	1/2	1/2	31/32	50

Bulk Cartons

12-202	(NPC-2)	1/8	3/8	3/4	2 1/4	1,000
12-203	(NPC-3)	3/16	3/8	3/4	3/8	1,000
12-204	(NPC-4)	1/4	3/8	3/4	13/32	1,000
12-205	(NPC-5)	5/16	3/8	3/4	29/64	1,000
12-206	(NPC-6)	3/8	3/8	3/4	15/32	1,000
12-207	(NPC-7)	1/2	3/8	3/4	33/64	1,000
12-208	(NPC-8)	1/2	3/8	3/4	35/64	1,000
12-209	(NPC-9)	9/16	1/2	1/2	5/8	1,000
12-210	(NPC-10)	5/8	1/2	1/2	21/32	1,000
12-211	(NPC-11)	1 1/16	1/2	1/2	47/64	—
12-212	(NPC-12)	3/4	1/2	1/2	25/32	1,000
12-214	(NPC-14)	7/8	1/2	1/2	27/32	500
12-216	(NPC-16)	1	1/2	1/2	29/32	500
12-218	(NPC-18)	1 1/8	1/2	1/2	31/32	—

Conduit Seals (Pennies)

- Steel
- Used to keep plaster out of conduit during construction



CAT. NO.	SIZE (IN.)	STD. CTN.
815	1/2	1,000
816	3/4	500
817	1	250
818	1 1/4	250
819	1 1/2	100
820	2	100
821	2 1/2	100
822	3	50
824-TB	4	100
823	3 1/2	25

Plastic Clamps — Polypropylene

- Polypropylene
- Cost effective
- Hole size .203 for #10 screw
- Temperature range -40°F to 221°F

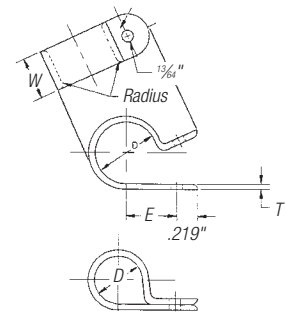

CAT. NO.	DESCRIPTION	DIMENSIONS (IN.)				STD. CTN.
		D	W	T	E	
12-502	(PPC-2)	1/8	1/2	1/8	23/64	1,000
12-503	(PPC-3)	3/16	1/2	1/8	27/64	1,000
12-504	(PPC-4)	1/4	1/2	1/8	29/64	1,000
12-505	(PPC-5)	5/16	1/2	1/8	1/2	1,000
12-506	(PPC-6)	3/8	1/2	1/8	17/32	1,000
12-507	(PPC-7)	7/16	1/2	1/8	9/16	1,000
12-508	(PPC-8)	1/2	1/2	1/8	19/32	1,000
12-509	(PPC-9)	9/16	1/2	1/8	5/8	1,000
12-510	(PPC-10)	5/8	1/2	1/8	21/32	1,000
12-511	(PPC-11)	1 1/16	1/2	1/8	3/4	1,000
12-512	(PPC-12)	3/4	1/2	1/8	25/32	500
12-516	(PPC-16)	1	1/2	1/8	29/32	—

Bulk Cartons

12-602	(PPC-2)	1/8	1/2	1/8	23/64	1,000
12-603	(PPC-3)	3/16	1/2	1/8	27/64	1,000
12-604	(PPC-4)	1/4	1/2	1/8	29/64	1,000
12-605	(PPC-5)	5/16	1/2	1/8	1/2	1,000
12-606	(PPC-6)	3/8	1/2	1/8	17/32	1,000
12-607	(PPC-7)	7/16	1/2	1/8	9/16	1,000
12-608	(PPC-8)	1/2	1/2	1/8	19/32	1,000
12-609	(PPC-9)	9/16	1/2	1/8	5/8	1,000
12-610	(PPC-10)	5/8	1/2	1/8	21/32	1,000
12-611	(PPC-11)	1 1/16	1/2	1/8	3/4	1,000
12-612	(PPC-12)	3/4	1/2	1/8	25/32	1,000
12-616	(PPC-16)	1	1/2	1/8	29/32	500

Hardware and Rough-In Products

Steel Cable Staples



CAT. NO.	SIZE (IN.)	DESCRIPTION	H (IN.)	W (IN.)	STD. CTN.
For NM Cable					
17-130TB	½	2 Wire #12 or #14	¾	½	5,000
17-140TB	½	Romex up to	¾	½	5,000
17-140B	½	½" Wide	¾	½	10,000*
17-140XB	½		¾	½	17,000
17-132	¾	3 Wire #10 or #12	1 ½	¾	5,000
17-142	¾	B X Romex; UF up	1 ½	¾	5,000
17-142B	¾	to ¾" Wide	1 ½	¾	8,000
17-123	¾	3 Wire #6 SEU	1 ½	¾	1,000
17-124TB	1	3 Wire #2 SEU	1 ½	1	1,000

* Reusable Plastic Bucket.

Plastic Cable Staples

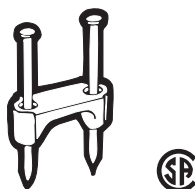

CAT. NO.	SIZE (IN.)	DESCRIPTION	STD. CTN.
17-214	½ (bag)	2 Wire, #12-#14 Romex,	500
17-224	½ (ctn.)	UF and other NM Cable	5,000
17-234	½ (ctn.)		5,000
17-215	¾ (bag)	3 Wire #10 or #12 Romex	500
17-225	¾ (ctn.)	UF up to ¾ Wire	5,000
17-235	¾ (ctn.)		5,000

CSA Certified.

Cable Protector Plate

- Protects wires, cords and cables from nail and screw penetration

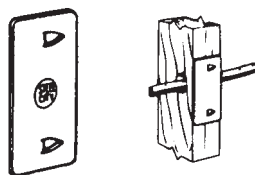

CAT. NO.	DESCRIPTION	STD. CTN.
CP-1	Steel Clip	100

Perforated Hanger Strap (¾" Wide, 20 Gauge)

- Galvanized finish
- Easily bends or twists to desired shape



CAT. NO.	DESCRIPTION	STD. CTN.
16-263	50' Bulk	1
16-264	100' Bulk	1

Drive Straps

CAT. NO.	EMT SIZE (IN.)	PIPE SIZE (IN.)	STD. CTN.
For EMT and Pipe (Zinc Plated)			
16-941	¾-½	¾	1,000
16-942	¾	¾	1,000



Service Entrance Cable Straps

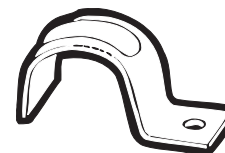

CAT. NO.	SE CABLE SIZE	STD. CTN.
ECS-6	3:6, 2:6, 1:8	100
ECS-2	3:2, 2:2, 1:4, 3:4	100
ECS-2/0	3:2/0, 3:1/0	50
ECS-4/0	3:4/0	50

Extra Duty One-Hole Snap-Straps



CAT. NO.	THINWALL CONDUIT SIZE (IN.)	STD. CTN.
16-910	½	500
16-911	¾	500

Hardware and Rough-In Products

Silicone Lubricant for High-Voltage Electrical Work

- Seals around junction boxes, flashings, service mast entries, service cable entries and countless other applications
- Easy to use, forms around irregular surfaces and configurations
- Highly resistant to cracking, drying and shrinking
- Cuts and trims easily



CAT. NO.	SIZE	STD. CTN.
SL-5	5 oz.	12

Duct Seal

- Can be painted immediately after application
- Gray color
- No unpleasant odor
- +20°F to 212°F workable temperature range
- -40°F to 250°F service temperature range
- Contains no asbestos

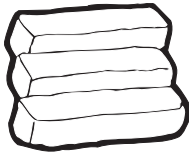

CAT. NO.	DESCRIPTION	STD. CTN.
DX-1	1 Lb. Slug	50
DX-5	(5) 1 Lb. Slugs	10
DX-5S	5 Lb. Slug	10

UL Classified R13335.

NOTE: Not classified as a "Fire Stop." For moisture and air sealing only.

Wire Bristle Brush

- For removing oxides from conductor surfaces
- Easy-grip handle with glove guard to prevent rubber glove puncture
- Long-life brushes can be rotated and are replaceable
- Handle and guard coated with durable non-conductive plastic



CAT. NO.	TYPE	STD. CTN.
WWB1	Complete Brush with Handle	6
WRB1	Wire Element Only, Pair	30

CONTAX® Oxide-Inhibiting Compound

- Seals electrical connections from oxygen and moisture
- Non-water soluble, non-petroleum based polymer grease
- Non-toxic, will not irritate the skin
- Service temperature to 460°F; can be applied in 0°F weather

CAT. NO.	SIZE	STD. CTN.
CTA	½ oz. Package	400
CTB	4 oz. Plastic Bottles	72
CTB8	8 oz. Plastic Bottles	12
CTQ	Quart Cans	6
CTG	Gallon Cans	2

CTO™ Conduit Threading Oil

This oil is a premium petroleum-type cutting oil, chemically compounded to provide an excellent lubricant and coolant for heavy-duty threading, cutting, tapping and drilling.

- Volume: 16 oz. aerosol, 1 quart, 1 gallon
- Chlorinated
- Odor: Slight
- Ingredients: None
- Viscosity: 425-450 SUS @ 100°F
- Flash Point: Above 400°F

CAT. NO.	DESCRIPTION	STD. CTN.
15-111	1 Quart	12
15-112	1 Gallon	4

Wire Testing Equipment

19-660C Audible Voltage Continuity Tester

T&B model 19-660C is designed for the everyday needs of the professional electrician and is made in the USA.

This Solenoid-type tester model's features include:

- Three voltage indications: Solenoid vibration sensing, electronic neon visual indication and audible buzzer
- Positive AC/DC voltage identification: 6 to 600 Volts 60/50 Hz
- Automatic testing for continuity through 300K ohms
- Electronic buzzer indication for AC/DC voltage and continuity
- Positive or negative DC pole identified by neon lamp
- Replaceable leads
- Retractable and locking, spring-loaded shrouds protecting metal probes
- Durable metal probes capable of piercing insulation-covered conductors
- Self-extinguishing, high-impact sealed case and prod assemblies prevent dirt, dust and small objects from entering the tester
- Includes A76 batteries
- Case serves as prod holder for one-handed operation



Model 19-660C



CAT. NO.	DESCRIPTION	STD. CTN.
19-660C	Audible Voltage/Continuity Tester—Solenoid Type	10

Receptacle Tester

- Conveniently tests receptacles for proper wiring, including polarity and presence of safety ground wire
- Easy-to-read indication legend
- Pocket size
- UL Listed, CSA Certified
- Label gives interpretations of all readings

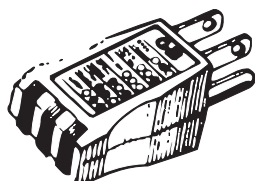

CAT. NO.	DESCRIPTION	STD. CTN.
19-060	Receptacle Tester for 120V Circuits	6

UL File E-80682.

High-Volt Testers

- 90–250 Volts AC/DC
- Convenient pocket clip on 19-079

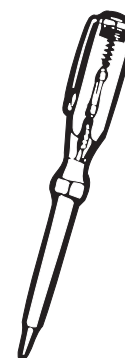

19-079

CAT. NO.	DESCRIPTION	STD. CTN.
19-079	Tester & Screwdriver, 5" Overall Length	6

Wire Caddy™

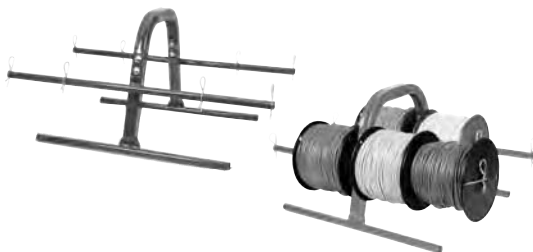

- Dispense small quantities of spooled wire
- Convenient hand-carrying design
- Constructed of steel tubing with premium powder-coat finish
- 3/8" hitch pin clip enables easy spool changes

CAT. NO.	DIMENSIONS (IN.)	STD. CTN.	STD. WT. (LBS.)	CAPACITY	
				QTY. OF SPOOLS	SPOOL DIMENSIONS
WK7001	22.75L x 14W x 11H	4	25	8	7" diameter x 5" wide
				4	7" diameter x 6"-10" wide

Shipping/Storage:

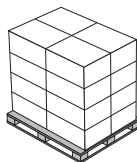

- Four units per master
- 64 pieces per pallet (16 masters)
- More than four times more product than the competition
- Lower freight costs

Wire Handling Kart™



- Dispense quantities of spooled wire
- Constructed of steel tubing with premium powder-coat finish
- 3/8" hitch pin clip enables easy spool changes

CAT. NO.	DIMENSIONS (IN.)	STD. CTN.	STD. WT. (LBS.)	CAPACITY	
				QTY. OF SPOOLS	SPOOL DIMENSIONS
WK7101	44.25L x 16W x 7.51H	2	47	12	7" diameter x 5" wide
				6	7" diameter x 6"-10" wide

Shipping/Storage:

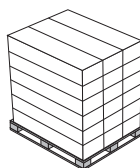

- Two units per master
- 36 pieces per pallet (18 masters)
- Lower freight costs

Multi-Purpose Wire Kart™



- Dispense large quantities of spooled wire
- Heavy-duty construction with premium powder-coat finish
- Five wire spool axles
- 3/8" hitch pin clip enables easy spool changes
- Built-in wire guide on handle enables horizontal dispensing
- Large 8" heavy-duty wheels with adjustable axle position
- Designed to pass through a 28" opening

CAT. NO.	DIMENSIONS (IN.)	STD. CTN.	STD. WT. (LBS.)	CAPACITY	
				QTY. OF SPOOLS	SPOOL DIMENSIONS
WK7103	25L x 28W x 55H	1	58.6	6	2500' — up to 16" diameter
				15	500' — 7" diameter x 5" wide

Shipping/Storage:

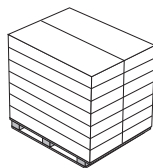

- 14 pieces per pallet
- Lower freight costs

Carlton®

Dispensers

Cable Dispenser



Floor Mount

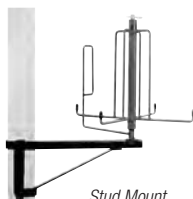

Stud Mount

- Two mounting styles in one product vs. competitive offering
- Floor or stud mount
- Smoothly dispense coils of armored cable or NM-B
- Swivel eyelet prevents tangles while paying out
- Wide base for stability
- Easy assembly, no tools required

CAT. NO.	DIMENSIONS (IN.)	STD. CTN.	STD. WT. (LBS.)	CAPACITY
				SPOOL DIMENSIONS
WK7203	15.5H x 19W	3	45.5	Inside — 5.50" min. inside coil dia. Outside — 17" max. outside coil dia. Max. Weight — 50 lbs.

Shipping/Storage:

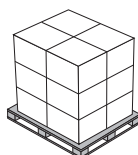

- Three units per master
- 36 pieces per pallet (12 masters)

6-Reel Wire Dispenser



- Dispense large quantities of spooled wire
- Heavy-duty construction with premium powder-coat finish
- Six angled spindles keep reels in place without locking
- Built-in wire guide
- Two fixed wheels, one locking swivel wheel
- Designed to pass through a 30" opening

CAT. NO.	DIMENSIONS (IN.)	STD. CTN.	STD. WT. (LBS.)	QTY. OF SPOOLS	CAPACITY
					SPOOL DIMENSIONS
WK7201	44L x 29W x 33H	1	80	6	2,500' — up to 18" diameter

Shipping/Storage:

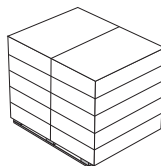

- 10 pieces per pallet
- Lower freight costs

10-Reel Wire Dispenser

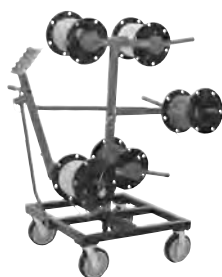

- All-steel construction
- Premium powder-coated finish
- Easy loading, dispensing and changing of spooled wire
- Adjustable wire guide
- Two fixed and two swivel locking casters for stability
- Angled spindles keep spools in place during use
- 360° rotating reel frame
- Fits through a 36" door opening
- Heavy duty
- Easy assembly

CAT. NO.	DIMENSIONS (IN.)	STD. CTN.	STD. WT. (LBS.)	QTY. OF SPOOLS	CAPACITY
					SPOOL DIMENSIONS
WK7202	50L x 32W x 57.5H	1	190	10	2,500' — up to 18" diameter

Shipping/Storage:

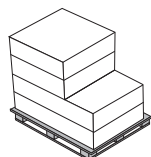

- Each unit shipped in two cartons
- Two pieces per pallet

Carlton®

Wire Safe® Wireway and Wiring Trough

Carlton® Wire Management Products

No wires to pull, no hard-to-work-with metal components.

Carlton® leads the way with the world's broadest line of non-metallic wiring management products designed for easier installation, greater performance and lower installed cost. That includes our Carlton® Wire Safe® wireway, wiring trough and fittings. It's the perfect solution for containing electrical, electronic and communication wire and cable. That's because it's easy to install, provides durable protection and eliminates the need to pull conductors, too. Just compare it point-for-point against the competition and you'll see why it's the best alternative for you.



Rugged Yet Lightweight.

UV stabilized, high-impact resistant PVC provides a strong, durable, non-corrosive, non-conductive housing for wire and cable. At the same time, components are so light and easy to handle that installation can be done by one person.

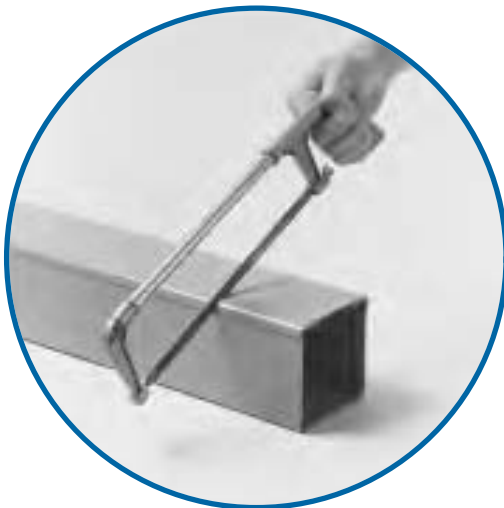

Easy to Cut and Assemble.

Wireway and trough can be cut easily and cleanly with either a hacksaw or fine tooth saw to make field fabrication a snap. And it's equally easy to couple components with either Carlton® primer and PVC cement or non-metallic push rivets.

Corporate Office
Tel: 901.252.8000
800.816.7809
Fax: 901.252.1354

Customer Service
Tel: 800.816.7809
Fax: 800.816.7810

Technical Services
Tel: 888.862.3289
Fax: 901.252.1321

Tool Services
Tel: 800.284.8665

Thomas & Betts

www.tnb.com

Carlton®

Wire Safe® Wireway and Wiring Trough

No Wires to Pull.

Once your wireway or trough is installed, just lay your wire and cable in, pop the cover on and you're done. It's as easy as that, and that's a lot easier than pulling wire or cable.

Easy to Rewire.

"Clip-on" cover design enables easy access for adding or removing wire and cable after initial installation.

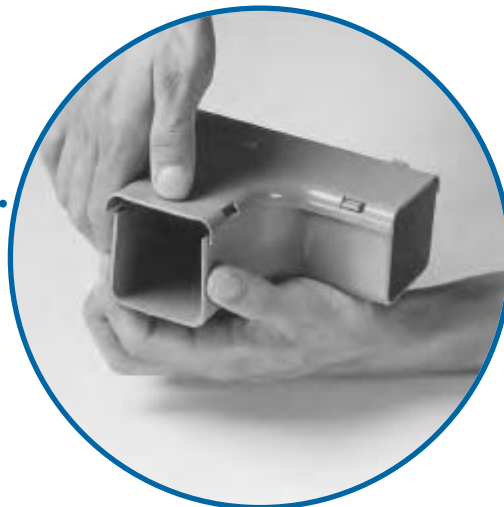

Application Flexibility.

Wireway and trough are suitable for a wide range of applications, from the most demanding commercial and industrial uses, including food service companies and chemical plants, to communication and computer facilities. Both wireway and trough can be used on walls, ceilings or across supports.

A Complete Non-Metallic System.

Both wireway and trough are available in 2" x 2", 3" x 3", 4" x 4" and 6" x 6" dimensions. Wireway comes cut in easy-to-use 10' lengths for larger jobs, and for tighter spaces, we offer specific lengths of wiring trough to fit distances of 1' to 10'. Both can be used with our non-metallic enclosures, conduit and fittings to create a total non-metallic wire and cable management system far superior to metal counterparts.

Improved NEMA 12 Wireway End Caps.

Our new wireway end caps are now made with pre-installed adhesive-backed gaskets. This new design makes them easier to use and also qualifies them for a NEMA 12 rating.



Wire Safe® Wireway

CAT. NO.	OUTSIDE NOMINAL DIMENSIONS (IN.)	LENGTH (FT.)	STD. CTN.	STD. WT. (LBS.) PER 10'
17011	2 x 2	10	1	4.7
17013	3 x 3	10	1	11.2
17015	4 x 4	10	1	11.2
17017	6 x 6	10	1	21.4

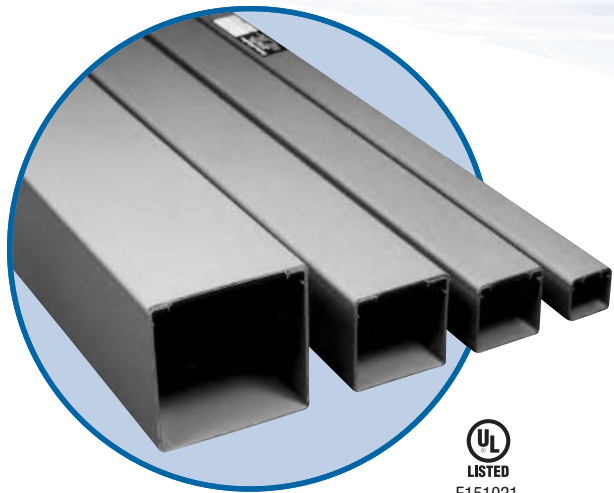

Wire Safe® Wiring Trough

CAT. NO.	OUTSIDE NOMINAL DIMENSIONS (IN.)	STD. CTN.	STD. WT. (LBS.)
12" Trough			
18111	2 x 2	1	0.6
18113	3 x 3	1	1.0
18115	4 x 4	1	1.4
18117	6 x 6	1	3.1
24" Trough			
18211	2 x 2	1	1.1
18213	3 x 3	1	1.8
18215	4 x 4	1	2.6
18217	6 x 6	1	5.3
36" Trough			
18311	2 x 2	1	1.5
18313	3 x 3	1	2.6
18315	4 x 4	1	3.7
18317	6 x 6	1	7.4
48" Trough			
18411	2 x 2	1	2.0
18413	3 x 3	1	3.3
18415	4 x 4	1	4.8
18417	6 x 6	1	9.6
60" Trough			
18511	2 x 2	1	2.5
18513	3 x 3	1	4.1
18515	4 x 4	1	5.9
18517	6 x 6	1	11.7
72" Trough			
18611	2 x 2	1	2.9
18613	3 x 3	1	4.9
18615	4 x 4	1	7.1
18617	6 x 6	1	13.8
120" Trough			
18011	2 x 2	1	4.8
18013	3 x 3	1	8.1
18015	4 x 4	1	11.6
18017	6 x 6	1	22.4

All wiring trough is made to order and is supplied with a pair of end caps.

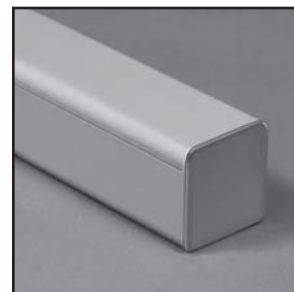
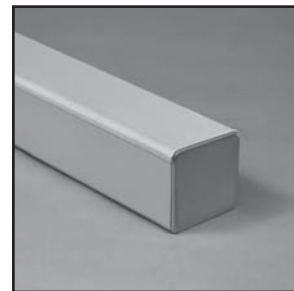

Carlton®

Wire Safe® Wireway and Wiring Trough

 Except where noted by ►
E151021

Wire Safe® Fittings

Flat Cross (Clip-On Cover)

CAT. NO.	SIZE (IN.)	STD. CTN.	STD. WT. (LBS.)
* EGFCJ	2 x 2	1	0.5
* EGFCF	3 x 3	1	1.3
† EGFCN	4 x 4	1	1.7
† EGFCR	6 x 6	1	4.8



90° Bend Flat Cover (Clip-On Cover)

CAT. NO.	SIZE (IN.)	STD. CTN.	STD. WT. (LBS.)
* EGLFJ	2 x 2	1	0.3
* EGLFL	3 x 3	1	0.6
† EGLFN	4 x 4	1	1.1
† EGLFR	6 x 6	1	3.3



90° Bend External Cover (Clip-On Cover)

CAT. NO.	SIZE (IN.)	STD. CTN.	STD. WT. (LBS.)
* EGLEJ	2 x 2	1	0.3
† EGLEL	3 x 3	1	0.8
† EGLEN	4 x 4	1	1.2
† EGLER	6 x 6	1	3.3



Flange

CAT. NO.	SIZE (IN.)	STD. CTN.	STD. WT. (LBS.)
► EGFIJ	2 x 2	10	1.1
► EGFL	3 x 3	10	1.4
► EGFN	4 x 4	10	2.2
► EGFR	6 x 6	10	3.0



End Cap (UL NEMA 12 Rated)

CAT. NO.	SIZE (IN.)	STD. CTN.	STD. WT. (LBS.)
* EGSEJ	2 x 2	10 Pair	0.6
* EGSEL	3 x 3	10 Pair	0.9
* EGSEN	4 x 4	10 Pair	1.6
†† EGSER	6 x 6	10 Pair	5.0



External Coupling

CAT. NO.	SIZE (IN.)	STD. CTN.	STD. WT. (LBS.)
EGCEJ	2 x 2	10	1.3
EGCEL	3 x 3	10	2.2
EGCEN	4 x 4	10	2.5
EGCER	6 x 6	10	7.8



90° Bend Internal Cover (Clip-On Cover)

CAT. NO.	SIZE (IN.)	STD. CTN.	STD. WT. (LBS.)
* EGLIJ	2 x 2	1	0.3
† EGLIL	3 x 3	1	0.7
† EGLIN	4 x 4	1	1.1
† EGLIR	6 x 6	1	3.0



Tee Flat Cover (Clip-On Cover)

CAT. NO.	SIZE (IN.)	STD. CTN.	STD. WT. (LBS.)
* EGTFJ	2 x 2	1	0.4
* EGTFI	3 x 3	1	0.9
† EGTFN	4 x 4	1	1.4
† EGTFR	6 x 6	1	3.8



Tee External Cover (Clip-On Cover)

CAT. NO.	SIZE (IN.)	STD. CTN.	STD. WT. (LBS.)
† EGTEJ	2 x 2	1	0.4
† EGTEL	3 x 3	1	0.9
† EGTEN	4 x 4	1	1.4
† EGTER	6 x 6	1	3.8

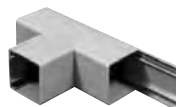

Internal Coupling

CAT. NO.	SIZE (IN.)	STD. CTN.	STD. WT. (LBS.)
► EGCIJ	2 x 2	10	1.3
► EGCIL	3 x 3	10	2.2
► EGGIN	4 x 4	10	2.5
—	6 x 6	N/A	N/A



Push Rivets

CAT. NO.	SIZE (IN.)	STD. CTN.	STD. WT. (LBS.)
► EGPR	N/A	200	0.4



Hangers

CAT. NO.	SIZE (IN.)	STD. CTN.	STD. WT. (LBS.)
► EGSEJ	2 x 2	10	0.9
► EGSEL	3 x 3	10	1.3
► EGSEB	4 x 4	10	1.9
► EGSEB	6 x 6	10	2.8



* Molded fitting — couplings not needed

† Fabricated fitting — order couplings separately

†† No coupling is required for 6" fabricated end cap

Thomas & Betts

www.tnb.com

Corporate Office
Tel: 901.252.8000
800.816.7809
Fax: 901.252.1354

Customer Service
Tel: 800.816.7809
Fax: 800.816.7810

Technical Services
Tel: 888.862.3289
Fax: 901.252.1321

Tool Services
Tel: 800.284.8665

Installation Instructions

Description.

Carlton® Wire Safe® Wireway and Wiring Troughs are manufactured from extruded PVC. The standard color is gray. The wireway consists of a base channel that is formed to receive a "clip-on" cover. Wiring troughs include a pair of ready-to-install end caps.

Cover Installation and Removal.

The cover can be installed by exerting hand pressure along its front face in such a manner as to engage and clip projections on the side walls of the base channel. The cover can be removed by inserting a tool (i.e., a screwdriver shaft) into one end of the wireway enclosure and exerting pressure against the underside of the cover, which is then "peeled off" from the base.

Wireway Fittings.

Fittings enable the wireway to be positioned around corners and enable tees and crosses to be created without detracting from the protective characteristics. Interconnecting pieces can be assembled using couplings and rivets or cement as necessary.

Molded fittings do not require couplings because they fit on the exterior of the wireway. However, primer and solvent cement are needed. **See cementing instructions on page G-24.**

Fabricated fittings do require internal or external couplings, and these must be ordered separately. To install fittings, a $\frac{1}{8}$ " diameter hole should be drilled in the wireway to match the external coupling hole. A push rivet should be used to connect the two pieces. To connect an internal coupling to the inside of a fitting, use Carlton® Quick-Set Clear Cement.

Applications.

These systems are designed for use in commercial and industrial areas. They may be used for the containment of electrical wiring/cables for power and lighting circuits and also communication and computer facilities. They are suitable for mounting on the surface of walls or ceilings or suspended across suitably positioned supports. Ambient temperatures should not exceed 122° F.

Installation.

1. Mark the surface upon which the wireway is to be mounted.
2. Measure, run and identify position of fittings.
3. Remove cover from wireway, starting at one end, with a peeling action (use of a screwdriver or similar lever is recommended).
4. Drill mounting holes through base at 36" centers maximum. Two rows of mounting holes should be drilled, adjacent to each wall of the wireway, in order to evenly distribute the load.
5. The holes in the wireway should be drilled oversize to enable expansion. Washers should be mounted under the head of the mounting device, which should not be tightened to its full extent.
6. Mount the wireway using screws or bolts.
7. Affix the wireway cover by aligning it to the wireway base and then pressing it into its engaged position, starting at one end.
8. The cover should be made to overlap the base joint in order to improve rigidity of the joint.

Engineering Specifications

Code Approvals.

Carlton's® Wire Safe® Wireway and Wiring Trough are recognized by the current National Electrical Code®, Article 378, for non-metallic wireways. It is UL Listed for electrical wiring up to 600 volts. UL File Numbers: UL E151021.

Specification for Carlton® Wire Safe Wireway and Wiring Trough.

- The wireway and wiring troughs shall be Carlton® Wire Safe Wireway and Wiring Trough.
- The Carlton® Wire Safe Wireway and Wiring Trough shall provide protection for electrical, low voltage, data and communication wiring or cables.
- The Carlton® Wire Safe Wireway and Wiring Trough shall be listed and installed per the NEC® Article 378 for non-metallic wireways.
- The Carlton® Wire Safe Wireway and Wiring Trough shall be manufactured from gray precision extruded Polyvinyl Chloride (PVC) meeting UL 94 V-0 requirements and shall be suitable for field painting.
- The Carlton® Wire Safe Wireway and Wiring Trough shall include base, cover, fittings, etc.
- The Carlton® Wire Safe Wireway and Wiring Trough shall provide all fittings required to form a complete, integrated surface raceway system. End caps shall be gasketed and shall have a NEMA Type 12 rating.
- The Carlton® Wire Safe Wireway and Wiring Trough shall provide raceway with the following cross sectional areas:

1. 2 x 2 — 3.165 in. ² (20.4 cm ²)	3. 4 x 4 — 13.694 in. ² (88 cm ²)
2. 3 x 3 — 7.378 in. ² (47 cm ²)	4. 6 x 6 — 31.871 in. ² (205 cm ²)

Fittings.

Internal and external elbow shall be a fitting cover that snaps onto the main base. Flat elbows and flat tees shall be a fitting cover that snaps on to the main base. End caps shall be gasketed and NEMA Type 12 rated.

Installation.

Install in accordance with the manufacturer's instructions, NFPA 70 and NECA standard. Install base, cover, fittings, accessories, etc., as necessary for a complete system.

Carlton®

Wire Safe® Wireway and Wiring Trough

Cementing Instructions

1. Make a square cut using a miter box or precisely marked line on the wireway to provide a smooth connection.
2. Make certain surfaces to be bonded are free of dirt, dust, etc., by wiping them clean with a rag and by removing sawcut burrs with a knife or rasp.
3. With a dauber, place a coating of Carlton® Clear Primer on the wireway and its mating parts. Thoroughly coat the surfaces to be mated.
4. Allow the Carlton® Clear Primer a few seconds to soften the PVC surface (the time may need to be adjusted depending upon the temperature).
5. Apply a complete coating of Carlton® Quick-Set Clear Cement to matching ends that will be joined.
6. Hold the parts in position by exerting pressure on the surfaces with clamps.
7. Allow 15 minutes or more before removing clamps.

Expansion And Contraction

Wireway will expand or contract with variations in temperature. To compensate for this expansion and contraction, during installation leave a 0.25" gap at joint, glue only one side of internal coupling or use external coupling with push rivets. All mounting holes should be drilled oversize and fasteners should not be tightened fully to allow for expansion and contraction.

Materials

PVC Homopolymer (ASTM F1784)	minimum cell class 12354B
Specific Gravity (ASTM D792)	1.46
Thermal Conductivity (ASTM C177)	1.3 Btu/hr./ft. ² /F/in.
Heat-Deflection Temperature @264 psi (ASTM D648)	70° C
Tensile Strength (ASTM D638)	6000 psi
Flammability (UL 94)	V-0

Physical Properties

SIZE (IN.)	CRUSH STRENGTH ¹ (LBS.)	IMPACT STRENGTH ² (FT.-LBS.)
2 x 2	650	40
3 x 3	500	30
4 x 4	500	40
6 x 6	600	50

1 — Load on 6" long sample just prior to wall buckling; fully recoverable.

2 — Five lb. weight with 1½" dia. face at 73° F.

Dimensions

OUTSIDE NOMINAL SIZE (IN.)	OUTSIDE ACTUAL SIZE (IN.)	INSIDE HEIGHT (IN.)	INSIDE WIDTH (IN.)	INSIDE AREA (IN. ²)	WIREWAY THICKNESS (IN.)	COVER THICKNESS (IN.)	WT./FT. (LB./FT.)
2 x 2	1.97 x 1.97	1.8	1.79	3.31	0.09	.08	0.6
3 x 3	2.96 x 2.96	2.8	2.76	7.94	0.10	.08	0.85
4 x 4	3.94 x 3.94	3.75	3.72	14.39	0.11	.08	1.48
6 x 6	5.91 x 5.91	5.67	5.67	13.48	0.12	.12	2.29

All information represents typical values and does not represent a minimum performance specification.

Clear Primer

CAT. NO.	STANDARD SIZE	STD. CTN.	STD. WT. (LBS.)
VC9903	Pint Dauber Top	24	27.0 lbs.
VC9902	Quart Dauber Top	12	25.0 lbs.

Cement and primer not needed for end caps.

All Weather Quick-Set Clear Cement

CAT. NO.	STANDARD SIZE	STD. CTN.	STD. WT. (LBS.)
VC9984	1/2 Pint Dauber Top	10	7.0 lbs.
VC9983	Pint Dauber Top	24	30.0 lbs.
VC9982	Quart Dauber Top	12	29.0 lbs.
VC9981P	Gallon Pour Top	6	54.0 lbs.



Wirefill Chart

CONDUCTOR SIZE AWG-MCM	AREA OF CONDUCTOR (SQ. IN.)				WIRE SAFE® WIREWAY SIZE AND MAXIMUM NUMBER OF CONDUCTORS ALLOWED (AREAS SHOWN ARE 20% OF THE FULL INTERIOR CROSS SECTIONAL AREA OF THE WIREWAY)															
	A	B	C	D	2X2 (0.6 IN. ²)				3X3 (1.5 IN. ²)				4X4 (2.7 IN. ²)				6X6 (6.4 IN. ²)			
	RFH-2, RH, RHH, ***RHW, ***SF-2	TF, THW, †TW	TFN, THHN, THWN	XHHW, ‡ZW	A	B	C	D	A	B	C	D	A	B	C	D	A	B	C	D
18	.0167	.0088	.0062	—	36	68	96	—	89	170	241	—	161	306	435	—	383	727	1032	—
6	.0196	.0109	.0079	—	31	55	76	—	76	137	189	—	137	247	341	—	326	587	810	—
14	.0230	.0135	.0087	—	26	44	69	—	65	111	172	—	117	200	310	—	278	474	735	—
14	*.0327	—	—	—	18	—	—	—	45	—	—	—	82	—	—	—	195	—	—	—
14	—	†.0206	—	.0131	—	29	—	46	—	72	—	114	—	131	—	206	—	310	—	488
12	.0278	.0172	.0117	—	21	35	51	—	53	87	128	—	97	156	230	—	230	372	547	—
12	*.0384	—	—	—	16	—	—	—	39	—	—	—	70	—	—	—	166	—	—	—
12	—	†.0252	—	.0167	—	24	—	36	—	59	—	89	—	107	—	161	—	253	—	383
10	.0460	.0222	.0184	—	13	27	33	—	32	67	81	—	58	121	146	—	139	288	347	—
10	—	.0311	—	.0216	—	19	—	28	—	48	—	69	—	86	—	125	—	205	—	296
8	.0845	.0471	.0373	—	7	13	16	—	17	31	40	—	31	57	72	—	75	135	171	—
8	—	†.0598	—	.0456	—	10	—	13	—	25	—	32	—	45	—	59	—	107	—	140
6	.1238	.0819	.0519	.0625	4	7	11	10	12	18	28	24	21	32	52	43	51	78	123	102
4	.1605	.1087	.0845	.0845	4	6	7	7	9	13	17	17	16	24	31	31	39	58	75	75
3	.1817	.1263	.0995	.0995	3	5	6	6	8	11	15	15	14	21	27	27	35	50	64	64
2	.2067	.1473	.1182	.1182	3	4	5	5	7	10	12	12	13	18	22	22	30	43	54	54
1	.2715	.2027	.1590	.1590	2	3	4	4	5	7	9	9	9	13	16	16	23	31	40	40
1/0	.3107	.2367	.1893	.1893	2	2	3	3	4	6	7	7	8	11	14	14	20	27	33	33
2/0	.3578	.2781	.2265	.2265	1	2	2	2	4	5	6	6	7	9	11	11	17	23	28	28
3/0	.4151	.3288	.2715	.2715	1	1	2	2	3	4	5	5	6	8	9	9	15	19	23	23
4/0	.4840	.3904	.3278	.3278	1	1	1	1	3	4	4	4	5	6	8	8	13	16	19	19
250	.5917	.4877	.4026	.4026	1	1	1	1	2	3	3	3	4	5	6	6	10	13	15	15
300	.6837	.5581	.4669	.4669	—	1	1	1	2	2	3	3	3	4	5	5	9	11	13	13
350	.7620	.6291	.5307	.5307	—	—	1	1	1	2	2	2	3	4	5	5	8	10	12	12
400	.8365	.6969	.5931	.5931	—	—	1	1	1	2	2	2	3	3	4	4	7	9	10	10
500	.9834	.8316	.7163	.7163	—	—	—	—	1	1	2	2	2	3	3	3	6	7	8	8
600	1.1940	1.0261	.8791	.9043	—	—	—	—	1	1	1	1	2	2	3	3	5	6	7	7
700	1.3355	1.1575	1.0011	1.0297	—	—	—	—	1	1	1	1	2	2	2	2	4	5	6	6
750	1.4082	1.2252	1.0623	1.0936	—	—	—	—	1	1	1	1	1	2	2	2	4	5	6	5
800	1.4784	1.2908	1.1234	1.1499	—	—	—	—	1	1	1	1	1	2	2	2	4	4	5	5
900	1.6173	1.4208	1.2449	1.2668	—	—	—	—	—	1	1	1	1	1	2	2	3	4	5	5
1000	1.7530	1.5482	1.3623	1.3893	—	—	—	—	—	—	1	1	1	1	1	1	3	4	4	4
1250	2.2062	1.9532	—	1.7671	—	—	—	—	—	—	—	—	1	1	—	1	2	3	—	3
1500	2.5475	2.2751	—	2.0612	—	—	—	—	—	—	—	—	1	1	—	1	2	2	—	3
1750	2.8832	2.5930	—	2.3779	—	—	—	—	—	—	—	—	—	1	—	1	2	2	—	2
2000	3.2079	2.9013	—	2.6590	—	—	—	—	—	—	—	—	—	—	—	1	1	2	—	2

* Dimensions of RHH and RHW.

*** Dimensions of RHH and RHW without outer covering are the same as THW No. 18 through No. 10, solid as well as No. 8 and larger, stranded.

† Dimensions of THW in sizes No. 14 through No. 8. No. 6 THW and larger are same dimension as TW.

‡ No. 14 through No. 2.

NOTES:

1) The ampacities of the conductors shall be reduced as shown in the table below.

2) Refer to the National Electrical Code® for ambient temperature correction factors.

COLUMN A — PERCENT OF VALUES IN TABLES AS ADJUSTED FOR AMBIENT TEMPERATURE IF NECESSARY		COLUMN B** — PERCENT OF VALUES IN TABLES AS ADJUSTED FOR AMBIENT TEMPERATURE IF NECESSARY	
NUMBER OF CONDUCTORS		NUMBER OF CONDUCTORS	
4 through 6	80	4 through 6	80
7 through 9	70	7 through 9	70
10 through 24*	70	10 through 20	50
25 through 42*	60	21 through 30	45
43 and above*	50	31 through 40	40
—	—	41 through 60	35

* These factors include the effects of a load diversity of 50 percent. ** No diversity.

EZCODE®

EZL500 Thermal Label Printer

NEW!

The industry's most sophisticated label printer is also the easiest to use. It's so smart, it's simple!

EZL500 Thermal Label Printer

- Large LCD screen makes viewing easy
- Powerful firmware is easy to use and update
- Ergonomic design makes it easy to carry
- Thermal transfer technology enables you to print non-smearing labels
- Cut a label with just the touch of a button
- Large tape cassette maximizes the amount of tape media
- Wide output port makes it easy to collect your printed labels
- Backlit display enables use in low-light environments
- Oversized keys and spacing make it easy to type labels
- Integral cassette sensor automatically adjusts the unit to your tape's width and media type, eliminating reprogramming with each tape switch
- Can be outfitted with a long-life, rechargeable, 7.4V Li-ion battery



With the EZCODE® EZL500 thermal label printer, you can print the widest variety of labels used on the most surface types — and, you can use it in more work environments than any other thermal label printer on the market. Best of all, it's easier to use than any other thermal label printer. With the EZL500 printer, you'll be labeling cable jackets and other surfaces in no time at all!

It's easy to get a handle on things

The printer's simple-to-use but powerful firmware makes operation intuitive, so you won't spend valuable time reading the instruction manual. The ergonomically designed EZL500 printer fits comfortably in your hand. Rubber molding enables a firm grip, and helps to protect the unit in case of an accidental drop. The EZL500 printer features the largest backlit LCD screen of all handheld thermal label printers. It enables you to easily see information on display, and is especially useful in low-light conditions.



Thomas & Betts

www.tnb.com

Corporate Office
Tel: 901.252.8000
800.816.7809
Fax: 901.252.1354

Customer Service
Tel: 800.816.7809
Fax: 800.816.7810

Technical Services
Tel: 888.862.3289
Fax: 901.252.1321

Tool Services
Tel: 800.284.8665

EZCODE®

EZL500 Thermal Label Printer

Just print, cut and stick

Using thermal transfer technology, the EZL500 unit prints labels that won't smear. Based on average usage, the print head can be expected to last up to 10 years. Now that's reliability! The automatic cutter function enables you to cut a label with the touch of a button. And, unlike some competing models, the cutting blade can be easily changed.

Size matters

You'll appreciate the EZL500 printer's oversized, wide-spaced keys, so you won't hit multiple buttons by mistake. Use hard-coded function keys for immediate access to frequently used functions. Soft-menu keys are ideal for infrequent functions. Able to handle a variety of tapes ranging in size from 1/4"–1" wide, the EZL500 printer enables you to use more media than any other thermal label printer. The integral cassette sensor automatically adjusts the unit to your tape's width and media type — so you don't have to reprogram the printer with each cassette change!

Do more, do more longer

The EZL500 printer runs on six standard AA batteries or an optional, rechargeable 7.4V Li-ion battery. The Li-ion battery has a longer life than standard batteries, and lasts longer than most other rechargeable batteries.

In short, the EZL500 printer is ready to work on the lengthy jobs you have now, and the ones you'll be doing years down the road.



When you're working in tight spaces, the handy magnet strap lets you stick the EZL500 printer to a vertical metallic surface, freeing your hands until you need to use it again.



With the included PC connection software and built-in mini USB port, you can print directly from your computer and easily upgrade the software.

EZCODE® Label Printer

Corporate Office
Tel: 901.252.8000
800.816.7809
Fax: 901.252.1354

Customer Service
Tel: 800.816.7809
Fax: 800.816.7810

Technical Services
Tel: 888.862.3289
Fax: 901.252.1321

Tool Services
Tel: 800.284.8665

Thomas & Betts

www.tnb.com

G-27

EZCODE®

EZL500 Thermal Label Printer

EZL500 Thermal Label Printer



CAT. NO.	DESCRIPTION
EZL500	Handheld Thermal Label Printer (includes EZL500 Thermal Label Printer, EZ-1030C-WN label cassette, six AA batteries, quick-start guide and user's manual)
EZL500-KIT	Handheld Thermal Label Printer Kit with Accessories (includes EZL500 Thermal Label Printer, EZ-1030C-MP and EZ-1030C-WN label cassettes, PA-EZL500 power adapter, MS-EZL500 magnet strap, PCS-EZL500 PC software and USB cable, RB-EZL500 rechargeable battery, quick-start guide, user's manual and CC-EZL500 carrying case)

EZL500 Accessories



PA-EZL500



MS-EZL500



PCS-EZL500



RB-EZL500



CC-EZL500

CAT. NO.	DESCRIPTION
PA-EZL500	EZL500 Power Adapter
MS-EZL500	Magnet Strap for EZL500
PCS-EZL500	PC Software and USB Cable for EZL500
CC-EZL500	Hard Carrying Case for EZL500
RB-EZL500	EZL500 Rechargeable Battery

EZL500 Thermal Label Printer Tapes

- **Nylon** — Excellent for wire and cable wrapping on curved, textured and highly textured surfaces, these flexible labels feature EZ-Peel split backs and industrial-strength adhesive
- **Polyester** — Perfect for general labeling on flat or textured surfaces, these labels also come with EZ-Peel split backs and industrial-strength adhesive
- **Heat-Shrink** — Made of flame-retardant polyolefin with 3:1 shrink ratio for extra protection and wire and cable insulation, these labels meet MIL-DTL-23053/5 Class 1 and 3 Standards
- **Vinyl** — Able to resist oil, dirt, grime and solvents on smooth, textured or curved surfaces, this flexible label features an EZ-Peel split back and industrial-strength adhesive; it's excellent for indoor/outdoor use



EZ-1230C-WN



EZ-3430C-WP

CAT. NO.	MATERIAL	COLOR	WIDTH (IN.)
EZ-3830C-WN	Nylon	White	3/8
EZ-1230C-WN	Nylon	White	1/2
EZ-3430C-WN	Nylon	White	3/4
EZ-1030C-WN	Nylon	White	1
EZ-3830C-YN	Nylon	Yellow	3/8
EZ-1230C-YN	Nylon	Yellow	1/2
EZ-3430C-YN	Nylon	Yellow	3/4
EZ-1030C-YN	Nylon	Yellow	1
EZ-3830C-WP	Polyester	White	3/8
EZ-1230C-WP	Polyester	White	1/2
EZ-3430C-WP	Polyester	White	3/4
EZ-1030C-WP	Polyester	White	1
EZ-3830C-MP	Polyester	Metallic	3/8
EZ-1230C-MP	Polyester	Metallic	1/2
EZ-3430C-MP	Polyester	Metallic	3/4
EZ-1030C-MP	Polyester	Metallic	1
EZ-1410C-WHS	Heat-Shrink	White	1/4
EZ-3810C-WHS	Heat-Shrink	White	3/8
EZ-1210C-WHS	Heat-Shrink	White	1/2
EZ-1410C-YHS	Heat-Shrink	Yellow	1/4
EZ-3810C-YHS	Heat-Shrink	Yellow	3/8
EZ-1210C-YHS	Heat-Shrink	Yellow	1/2
EZ-1030C-SL	Self-Laminating Vinyl	White/Clear	1